

T
R
A
I
N
S
O
F
T
D
I
E
S
R

Division One of the
North Central Region of the
National Model Railroad Assoc.



Our mission is to promote education and fellowship through the sharing of information and the promotion of the world's greatest hobby. — **Model Railroading.**

Railroad Item of the Month

Your photo can be here if you just send us one.



Ray Heiler

A BLAST FROM THE PAST

You are in Toledo but, where? Hint - the left two tracks are part of the former NYC 4 track mainline and you are looking west.

See Page 8 for answer

VIEW FROM THE CAB

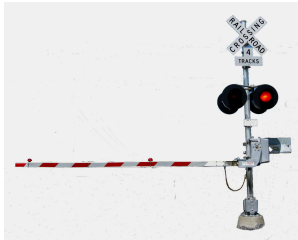

What do model railroad “operations” mean to you? You may be an avid ops fan, have zero interest, or fall somewhere in between. You may love certain aspects of ops and dislike others. You may find operations exciting, boring, stimulating, confusing, or a mixed bag of these emotions and more. Perhaps you are intimidated by lack of understanding and knowledge on the subject. Or maybe you have a wealth of experience and know-how in the ops realm. Well here’s the point: our membership represents all of the above! Even though we don’t all call ourselves “operators”, when the juice hits the rails and the first wheel turns, we are operating! Model railroads are not static displays. They move, they simulate life, they express our imaginations through action. So learning more about operations has value for all of us to varying degrees.

There are many activities and resources for gaining knowledge and experience in operations, and that’s exactly what we are going to address in Division 1 over the next few months. We will kick things off at our October and November meetings with a two-part video clinic by author and ops expert Tony Koester to introduce some basics. Norm Cattell and Jim Treadaway will tell us about their plans to lead a series of monthly sessions at different host layouts where we will cover a series of topics, including discussion, questions, and hands-on practice. At our Division meetings through the Winter and Spring, we will include operations in our discussion activities as well. I am looking forward to learning more about what others are doing so I can develop a personal operating format for my own layout. If you were involved with the DCC “SIG” (special interest group) we had a few years ago that followed this same approach, I think you will agree we learned a lot, had fun, and built deeper friendships along the way. I heartily encourage you to join us at the October 23 meeting, see what’s coming, and get on board.

At the September meeting, I told you that we had exciting plans for this year’s Christmas party, and that big news is on the slate for October 23 as well. I guarantee you will not be disappointed, so mark your holiday calendars now and save Friday evening, December 18, for Division 1. I’m looking forward to seeing all of you at the upcoming meeting, and I’d like to see your friends too, so invite someone! Remember to bring models, tools, tips, digital pictures and videos to share during our usual membership activities.

See ya on down the line,
Dave McMullian, Superintendent

From the Editor's Desk

Ray Huber

Last month it was “DOOM & GLOOM! Time to get out of that funk and get on with it! However, I was serious about talking estate planning with the group. Like it or not, it’s one life’s realities and being responsible adults, we need to plan!



Now that fall is here, Train Shows will be showing up all over the place and guess what, I plan to attend a couple of them and yes I will probably buy something I really don’t need. At least I can say that I helped support the Hobby and those trying to do the same thing we should be doing.

What do you think about a Train Show sponsored by Division One? I know our Super Dave has talked about it before but, it never took roots. If nothing else, Division could have it’s own table/s at some other show. Anybody that wanted to sell their wares could chip in and help with the cost. Might even help promote the organization! Another topic for the Round Table.

Let’s move on to another topic. Last month we had some very interesting conversation about what we did over the summer. All good stuff and just proves the diversity of our group.

I was impressed by Mike Anteau’s show on electronics. He talked about things that are beyond me and I’m sure (assumption on my part) a lot of you.



However and as they say, “it’s my Railroad!” My only question is, Mike, do you every get the chance to actually run your own trains by turning the throttle or lining a switch by hand? All kidding aside, a great job and an open door for a clinic on what you can do with some of the new tools available to Model Railroaders. Think about it Mike but, know your audience and their skill levels!

The following three pages are the Editors comments and his alone. They were stated not to offend but, to highlight an issue that I myself have probably been guilty of over the years. If they offend, I offer no apologies because they were intended to bring to our attention an often overlooked area of public speaking and that is, know your audience’s skill level. I can say this because I speak from experience both as an educator and working in the public sector.

THE BASICS

At the last Division One meeting, the question was asked, how do I take a picture of a building and turn it into a backdrop? I don't recall the question every being fully answered because of the breadth of the topic. This brings to mind another case of, know your audience and their skill levels. I'm sure I'm going to step on a few toes this time but, here goes!



I did hear a lot about some very costly high end equipment & software and what it can do. Yes it can and well and good it can but, the room got very quiet and heads started to bob! This clearly was not the right time and place for an in-depth discussion of this complex topic.

If we are going to promote education, let's do it right. I know there are educators in the room and very savvy practitioner's. For our goal, let's start with the assumption that no one knows anything about the topic. What a great starting point. With that, I submit we should try to create programs that cover different topics and most importantly, start with the basics. For example, let's start with the camera - now how basic can that be? I've already had one member say to me, I have a digital camera but, I don't know how to use it and another, what do I look for in a camera? If you're not familiar with this technology, it can be daunting; basics first and then work into more complex topics down the line.



I accept the fact the question was asked but, it triggered my mind into thinking, if this is going to be meaningful, then it needs to be more organized and those with the expertise brought into the picture (no pun) at the right time. I ask all of you, is this really something we want to do collectively or should there be a SIG group (Special Interest Group) for this topic?



As an example, one of the new terms I had to learn and still learning about is, camera resolution. It can be confusing and numbers are part of the learning process. This one term has become the key factor many people consider when looking for a camera. Should it be? Let's talk about it.

From the GET GO, we are going to assume that everybody knows what a digital camera is! Are you sure? Have you asked?

The first digital camera I owned, a Kodak-4800, had a resolution of 1 mega pixels. What the heck is a MEG-A-PIXEL? It = 1,000,000 pixels! OK what's a pixel and so it goes. Is that good or bad? I might know if I knew what a pixel was and how it worked? I still look at those older pictures of mine and enjoy what I see. Therefore, it must be OK! Or maybe it could be better! There in lies the question!

Let's start with the definition of a PIXEL. If you look up *pixel* on the Web, you will find a rather technical and wordy definition that left me cold. Knowing what I know, I'll give you my simple version - A Pixel is a very small individual dot, actually a square, of light sensitive material placed on a small chip of material, now called a sensor, and placed in your camera. There are usually millions of these dots side by side and in rows that determine the resolution of your camera. The more pixels (squares) the higher the resolution. Think of it this way, pixels are like film, when light passes through the lenses of your camera and strikes the surface of the pixels, the pixels record all of the colors in the scene. Just like film, the finer the light sensitive particles or in this case, the more pixels on the sensor, a sharper and more detailed picture can be printed. Like developing film, the computer turns the recorded light on the sensor into a picture you can see, manipulate and print. Keep in mind , the sensor generally stays the same size but, the pixels get smaller and smaller yielding higher resolutions.

In the film days, the question was—what type of film are you using and then, what kind of camera do you have? Today it's what resolution is your camera and then, what is your camera? From my own experience, any camera with 8 to 10 Megs of resolution is just fine. It can make a very acceptable print up to 8.5x11 (letter size) using most any deck top printer on the market today. Watch out, that's another subject in the vast sea of digital photography.

One of the first questions a camera store will ask you is, what are you planning on doing with your camera? Well DUH—take pictures of family, vacations, print them, send to friends via email, send to the Train Order for publication and so forth and so on. A good question and I'll bet like most of us, your answer will be, all of the above. Rather than get into a major discussion in the Train Order, let's save it for a Round Table discussion at Division. Better yet, a clinic by a Division member. To start that dialog, I've inserted a Digital Camera Resolution chart I found on the internet. It will help you in making your resolution choice. See next page!

Now that the first step has been taken and the subject of camera resolution has been broached right here in the Train Order, tell me this, was this the right place to do so? You tell me if I'm wrong. If you don't like it, speak up but, be ready to contribute. It can be constructive criticism or maybe you can be a group leader on some topic you are good at. Make a clinic out of it!!

Point being, let's set the bar high but, let's raise the bar at a pace where everyone can enjoy and benefit from the learning experience.



As a finishing touch to a rather windy dissertation, I found this chart on line while checking out a new camera. Yes, I'm looking at the resolution of a new camera and the telephoto capability of the camera. However, I'm a little set back by the f-stop range of the unit. All of these things are good topics for future discussions at a Digital Camera round table.

CAMERA RESOLUTION CHART

Capture Resolution	Video Display*	Print Size***						
		2x3"	4x5"/4x6"	5x7"	8x10"	11x14"	16x20"	20x30"
320x240	Acceptable	Good	Acceptable	Poor	Poor	Poor	Poor	Poor
640x480 - 0.3 Megapixel	Good	Excellent	Good	Poor	Poor	Poor	Poor	Poor
800x600	Excellent	Photo Quality	Very Good	Acceptable	Poor	Poor	Poor	Poor
1024x768	Excellent	Photo Quality	Excellent	Good	Acceptable	Poor	Poor	Poor
1280x960 - 1 Megapixel	Excellent	Photo Quality	Photo Quality	Very Good	Good	Poor	Poor	Poor
1536x1180	Excellent**	Photo Quality	Photo Quality	Excellent	Very Good	Acceptable	poor	poor
1600x1200 - 2 Megapixel	Excellent**	Photo Quality	Photo Quality	Photo Quality	Very Good	Acceptable	Acceptable	Poor
2048x1536 - 3 Megapixel	Excellent**	Photo Quality	Photo Quality	Photo Quality	Excellent	Good	Acceptable	Acceptable
2240x1680 - 4 Megapixel	Excellent**	Photo Quality	Photo Quality	Photo Quality	Photo Quality	Very Good	Good	Acceptable
2560x1920 - 5 Megapixel	Excellent**	Photo Quality	Photo Quality	Photo Quality	Photo Quality	Excellent	Very Good	Very Good
3032x2008 - 6 Megapixel	Excellent**	Photo Quality	Photo Quality	Photo Quality	Photo Quality	Photo Quality	Excellent	Very Good
3072x2304 - 7 Megapixel	Excellent**	Photo Quality	Photo Quality	Photo Quality	Photo Quality	Photo Quality	Excellent	Excellent
3264x2448 - 8 Megapixel	Excellent**	Photo Quality	Photo Quality	Photo Quality	Photo Quality	Photo Quality	Photo Quality	Excellent
10 Megapixel +	Excellent**	Photo Quality	Photo Quality	Photo Quality	Photo Quality	Photo Quality	Photo Quality	Photo Quality

- Poor Noticeably Grainy (pixelated)
- Acceptable Obviously not a real photo, but some details are visible
- Good Can tell it is not a photo but most details are discernable
- Very Good Can tell it is not a photo at normal distance, but good enough for many uses
- Excellent Difficult to tell from real photo at normal viewing distance
- Photo Quality On a photo-quality printer, the human eye should not be able to tell the difference at a normal viewing distance

* Either television or computer display (e.g. Web Page)
 ** Will produce an excessively large file size that would be inappropriate for web applications
 *** Using a typical Photo Quality Desktop printer

A Unique Railroad Item by: Steve Kellogg

Steve Kellogg is at it again! I don't know where he finds these oddities but, keep them coming Steve!

Here's one of his latest finds, a railroad round-about, around a round building. Someone even modeled it—that person has too much time on their hands!



I WOULD GUESS NEW JERSEY

RECOGNIZE THIS? →

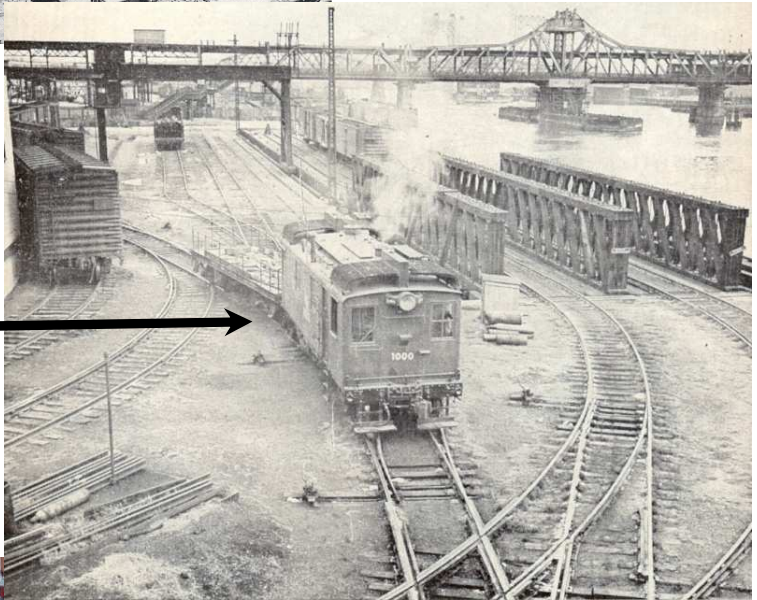

NICE MODEL



Here's the **answer** to the question, where was the cover picture taken? If you were around Toledo in the late 60's, 1967 if I recall, you might remember the pedestrian walkway over Airline Yard near Libbey High School. Just to the right of where I was standing was a yard tower that the operator/s accessed from this walkway. As you can see, it was a great viewing spot and best of all, no one cared if you were there.

It's all gone now but, the memories still remain. Even the two worms doing their thing are gone. It's hard to believe that two giants of the rail disappeared so quickly. Fallen flags for sure but, not forgotten!



LADIES IN WAITING
Central Union Depot circa
1976

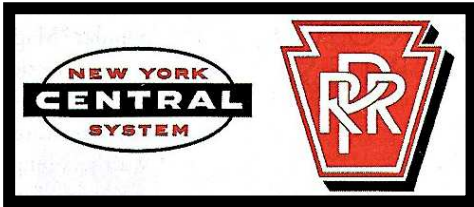

Last Run West

SPECIAL NOTICE

Thanks to our host **Rick Breitzman**, there will be an open house Model Railroad tour scheduled for the Saturday after this months Division meeting. Hope you can make it!

Visit the *“Toad Mountain Railroad”*

October 24, 2015

10:00 A.M. – 2:00 P.M.

4205 Mitchaw Road
Sylvania, OH 43560



July 25



August 17



August 25

First battery train running lower loop



September 17

See Map next Page



4205 Mitchaw Rd
4205 Mitchaw Rd, Sylvania, OH 43560

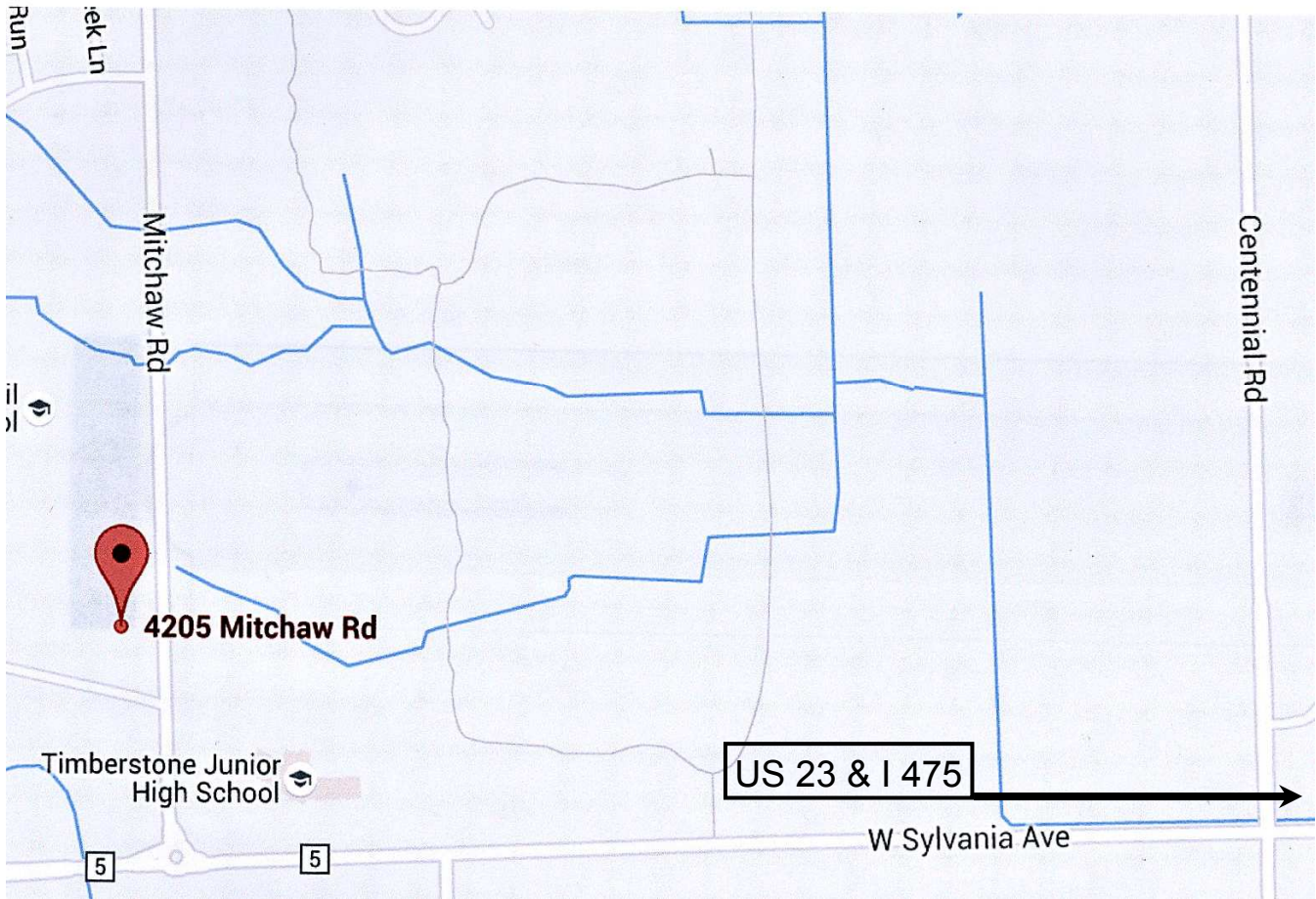

What do you think this guys chances are for advancement?

From the files of Steve Kellogg

Here are four Train Shows that will be in our area.

DAYTON TRAIN SHOW
NOVEMBER 7 & 8, 2015
SAT 11:00 AM—5:00 PM
SUN 11:00 AN—4:00 PM
HARA ARENA
DAYTON, OHIO

ANN ARBOR MODEL RAILROAD CLUB
FEBRUARY 13 & 14, 2016
SAT 10AM—4PM
SUN 10AM—3PM
SALINE MIDDLE SCHOOL—SALINE, MI

FREMONT MODEL TRAIN SHOW & SWAP MEET
FEBRUARY 28, 2016
10:00 AM—3:00 PM
FREMONT COMMUNITY RECREATION COMPLEX
FRE,PMT, OHIO

BUCYRUS MODEL RAILROAD ASSOC.
TRAIN SHOW & SWAP MEET
APRIL 9, 2016
10:00 AM—4:00 PM
CRAWFORD COUNTY FAIRGROUNDS
BUCYRUS, OHIO

HAVE NOT SEEN THE DATE FOR
THE LANSING SHOW!



We meet at the Collingwood Presbyterian Church located at 2108 Collingwood Blvd. at Floyd St. near downtown Toledo, Ohio. See the location map shown below. The doors open at **6:30 PM** and the meeting starts at **7:00 PM**.

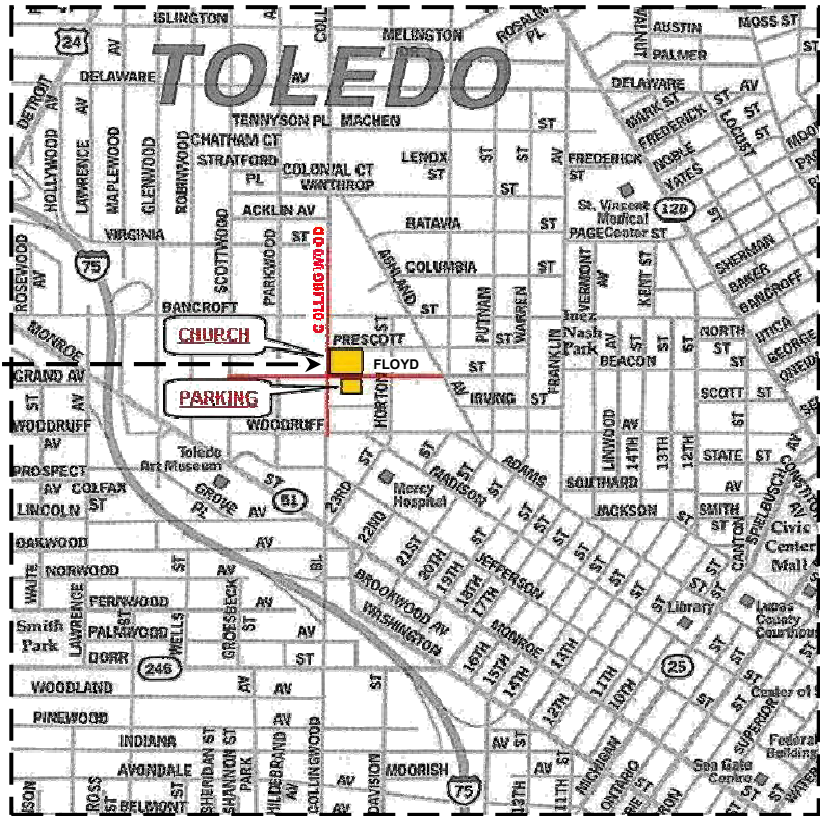

CURRENT OFFICERS 2014 - 2015

- Superintendent -Dave McMullian.....davemcmullian@earthlink.net
- Assistant Superintendent -Jim Lang.....jlang@buckeye-express.com
- Chief Clerk -John Roth.....jroth@bex.net
- Agent -Phil Kauffman.....pennsy6401@bex.net
- Trainmaster for Services -Steve Kellogg.....atsfmktrock@yahoo.com
- Director at Larger -Ray Huber.....rahuber@bex.net
- Train Order Editor -Ray Huber.....rahuber@bex.net
- Librarian -John Roth.....jroth@bex.net
- Librarian -Dex Decker.....dexdecker@gmail.com

Division One is a 100% NMRA membership organization. For insurance purposes, you are required to be a member of NMRA. Membership in NMRA grants you membership in the North Central Region and Division One.