

T
R
A
I
N
O
R
D
E
R

Division One of the
North Central Region of the
National Model Railroad Assoc.

Our mission is to promote education and fellowship through the sharing of information and the promotion of the world's greatest hobby. — **Model Railroading.**



Railroad Item of the Month

Your photo can be here if you just send us one.



OK everybody, where are we? As for a date, I'm guessing the early 50's. In any event, our thanks to Steve Kellogg for sharing with us a great photo of a great lady. I can't help but marvel at the complexity of a steam locomotive realizing that all of those parts move in unison once steam courses through her lines. Pure poetry in motion!

Remember, our next meeting is Dec. 1st

View from the Cab

Nov 2017

As Thanksgiving rolls around, we've had to reschedule our November meeting to December 1. As you are probably aware, one of the priorities for that meeting will be the "distribution" of the Division One library to our members. So what brought this on, and what exactly does it mean? Well, over the years we've accumulated a substantial collection of books, magazines, and video media. While the depth and quality have been excellent, our members have just not had enough access to put the resources to effective use. Since most of the materials have been donated by members, we want to distribute them via a fair and equitable process. This is not about making money, but rather is intended simply as a benefit to the members. The process will be twofold: first, we'll have a "silent auction" where members can submit cash bids on any materials they want. The prices will be VERY low, with the intent of giving everyone interested a fair shot. Following that, we'll allow each member present to select a remaining item or lot free of charge and continue until everything is gone. This is a quick summary, but we've worked out the details and it will be fast and fair. **If you have donated materials that you would like returned, please do so prior to the start of the meeting!** And if you are interested in the silent auction, bring some cash – things will start at one dollar and go up in whole dollars, no coins. Again, minimums will be LOW, so you can expect some bargains unless a bidding war breaks out! One thing is guaranteed: everyone will walk out of the meeting with something they want.

The main modeling activity will be a panel presentation and discussion regarding structure-building techniques. A number of subtopics will be presented and include materials, tools, and methods. We'll have some specialists on plastic and wood models. Don't forget to bring something for Show-n-Tell, particularly any structures you've been working on.

Don't forget the Christmas Party on December 15! Sign up, select your meal, and pay for tickets at the December 1 meeting. You'll have another opportunity to ask questions if needed. Meeting starts at 7 PM as usual, but feel free to come any time after 6 to visit with friends and help set up.

See ya on down the line,
Dave McMullian
Superintendent



From the Editor's Desk

Ray Huber

Ok, how many of you went home and tried your hand at weathering? I got an old "Blue Box" box car out and gave it a try. What you see here are the results of using a very light wash of Burnt Sienna with a little heavier coat on the trucks and wheels. Just look at the difference between the weathered car (left) and a just out of the box car. Sure helps if that's the look you're looking for!



Kudu's to Norm for keeping us under control and running the last meeting in Dave's absence. Thanks also for adding his own tips and techniques to the weathering clinic featured this month. It would be nice to see some of your results next month during our Show & Tell period or better yet, in the Train Order.

In case you did not see the announcement, Division One is having it's Annual Holiday Party on Dec. 15th, at the Swan Creek living center. Again, Chuck Williams is our host and from what we heard, we're in for another grand evening of food and fun. The program cost is \$15.00 along with any donation you would like to offer. Chuck can accept your payment at the Dec. 1st meeting (remember no meeting in November).

Also and if you are so inclined, bring a gift wrapped gift for the Chinese Auction. Any gift in the \$15.00 to \$20.00 value range is welcome. Please bring something new or at least in it's original box and not some used cast off that you don't want on your layout.

Between now and next meeting, I hope you and your family have a Wonderful and Happy Thanksgiving.

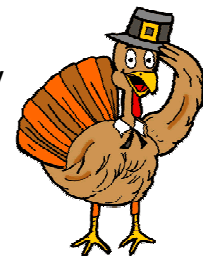

COMING ATTRACTIONS

GRAND RIVER VALLEY RAILROAD CLUB - WYOMING, MI WWW.GRANDRIVERVALLEYRRC.ORG

LISTING OF TRAIN SHOWS & NMRA EVENTS 2017 - 2018 MI, OH, & IN

10/27/2017

DATE SHOW LOCATION SHOW SPONSOR

DATE	SHOW	LOCATION	SHOW SPONSOR
12/2/2017	The Great Train Show (2 days)	Fort Wayne, IN - Allen War Memorial Coliseum	greattrainshow.com
12/2/2017	Marion Union Station Association 32nd Train Show	Marion, OH - Veterans Memorial Coliseum	Marion Union Station Association 740-383-3768
12/3/2017	Christmas Xtravaganza Model Railroad & Train Show	Medina, OH - Medina Fairgrounds	Conrad & Dowdell Productions 330-948-4400
12/3/2017	Springfield Model Train Show	Springfield, OH - Clark County Fairgrounds	Bob Chaffin, 937-399-6647
12/3/2017	Model Train Show & Sale	Wyoming, MI - Knights of Columbus Hall	West MI Model RR Club (616) 291-5823
12/9/2017	Warsaw Model Train Show	Warsaw, IN - Kosciusko County Fairgrounds	Gabe Fitzsimmons - 574-527-8554
12/9/2017	Naptown & White River Train Show	Indianapolis, IN - Manual High School Gymnasium	Naptown & White River Club 317-786-8627
12/9/2017	62nd Buckeye Train Show	Columbus, OH - Lausche Bldg. Ohio Expo Center	Golden Spike Enterprises (330) 755-1914
12/10/2017	Christmas Toy & Train Show	Kirtland, OH - Lakeland Community College	Cleveland Train Shows, Inc. 440-256-8141
12/10/2017	Trains and Trade Show	Commerce Twp., MI - Beacon Hill Golf Course	Brian McKee, 248 698-3961
12/10/2017	Massillon Train & Toy Show	Massillon, OH - Knights of Columbus Cherry Rd	Jon Ulbright, 330-262-7488
12/10/2017	Great Midwest Train Show	Wheaton, IL - DuPage County Fair Grounds	greatmidwesttrainshow.com
12/16/2017	Train Town Train Show	Lima, OH - Allen County Fairgrounds	NMRA NCR Div. 3 (567) 259-3340
12/17/2017	Wolverine Railroad Holiday Toy & Train Show	Madison Heights, MI - UF & C Workers Hall	Wolverine Model RR Club (586) 662-0225
1/6/2018	Snow Dogs Train Show	Parma, OH - UAW Hall Chevrolet Blvd.	Cuyahoga Valley S Gauge 440-526-9864
1/6/2018	26th Annual Riverbend Train Show	Wyoming, MI - HSB, Inc	Ron Lamfers 616-662-1221
1/13/2018	The Great Train Show (2 days)	Columbus, OH - Ohio Expo Center	greattrainshow.com
1/14/2018	Great Midwest Train Show	Wheaton, IL - DuPage County Fair Grounds	Trainshow.com
1/14/2018	Toy Train & Model RR Flea Market	Salem, OH - Salem Center Plex	Youngstown Model RR Assoc. 330-547-3614
1/14/2018	A Train Show	Auburn Hills, Mim - Avondale High School	Avondale Education Foundation (248) 537-6008
1/14/2018	Wolverine Railroad Toy & Train Show	Madison Heights, MI - UF & C Workers Hall	Wolverine Model RR Club (586) 662-0225
1/21/2018	Dayton All Trains Flea Market	Lebanon, OH - Warren County Fair grounds	Larry Zeller 937-773-7186
1/27/2018	TCA Winter Train Meet	Parma, OH - UAW Hall 5615 Chevrolet Blvd.	Ed Mularz 440-665-0882
1/28/2018	Ole Toy & Train Show	Redford, MI - St Robert Bellarmine School Gym	Brian Klotzer, 313-255-0466 6:00PM-10:00 PM
1/28/2018	Winter Railroad Swap Meet & Monon RR Movie Program	Griffith, IN - American Legion Post 66	Blackhawk Railway Hist. Society 815-834-0835
1/28/2017	Noblesville Train Show	Noblesville, IN - Hamilton Co. 4-H Fairgrounds	NMRA MWR Central IN Div. (812) 876-6799
2/3/2018	Model Train Show and Sale	Auburn, IN - Kruse WWII Museum	RxRmania.com (260) 627-2176
2/3/2018	The Great Train Show (2 days)	Indianapolis, IN - Indiana State Fairgrounds	greattrainshow.com
2/4/2018	Railroadiana Toys & Trains	Westland, MI - SS Simon & Jude Church Hall	SS Simon & Jude Ushers' Club 734-728-1247
2/4/2018	Medina Toy & Train Show	Medina, OH - Medina Fairgrounds	Conrad & Dowdell Productions 330-948-4400
2/10/2018	St Andrew's Model Train Show	Milford, OH - St Andrew Parish Center	St Andrew's Holy Name Society (513) 732-2793
2/11/2018	Mansfield Train Show	Mansfield, OH - Richland Co. Fairgrounds	Dennis Breese 419-606-7934
2/11/2018	Great Midwest Train Show	Wheaton, IL - DuPage County Fair Grounds	greatmidwesttrainshow.com
2/11/2018	Wolverine Railroad Holiday Toy & Train Show	Madison Heights, MI - UF & C Workers Hall	Wolverine Model RR Club (586) 662-0225
2/17/2018	Das Dutchman Essenhaus Train Show	Middlebury, IN - Das Dutchman Essenhaus	Das Dutchman Essenhaus (800) 455-9471 x443
2/17/2018	48th Annual Train Show & Sale (2 days)	Saline, MI - Saline Middle School	a2trainshow.com 734-426-0829
2/24/2018	The Great Train Show (2 days)	Novi, MI - Suburban Collection Show place	greattrainshow.com
2/25/2018	Lapeer Model RR Swap Meet	Lapeer, MI - American Legion Post # 16	Vern Sollman 810-441-0091
2/25/2018	Michigan City Swap Meet	Michigan City, IN - NECA/IBEW Community Center	Duneland Model Railroad Club (219)778-1186

COMING ATTRACTIONS

GRAND RIVER VALLEY RAILROAD CLUB - WYOMING, MI WWW.GRANDRIVERVALLEYRRC.ORG

LISTING OF TRAIN SHOWS & NMRA EVENTS 2017 - 2018

MI, OH, & IN

10/27/2017

DATE	SHOW	LOCATION	SHOW SPONSOR
3/3/2018	Independence Train & Toy Show	Independence, OH - Independence High School Fieldhouse	Dennis Peffer 216-642-0692
3/4/2018	Darke Co. Model RR Swap Meet	Greenville, OH - Darke Co. Fair Grounds	Darke Co. Model RR 937-621-1569
3/10/2018	Cincinnati Div. 7 NMRA Spring Flea Market	West Chester, OH - Lakota West Freshman Campus	NMRA MCR Cincinnati Div. 7 513-662-7245
3/11/2018	Wolverine Railroad Toy & Train Show	Madison Heights, MI - UF & C Workers Hall	Wolverine Model RR Club (586) 662-0225
3/11/2018	Great Midwest Train Show	Wheaton, IL - DuPage County Fair Grounds	greatmidwesttrainshow.com
3/11/2018	Mid Michigan Model Train Show	Mt Pleasant, MI - CMU Finch Fieldhouse	Saginaw River Valley RR Club 989-439-2188
3/11/2018	Greater Toledo Toy & Train Show	Perrysburg, OH - Owens Community College	Randy Ramsey (419) 215-4181
3/17/2018	Railfest 2018 (2 Days)	Kirtland, OH - Lake Community College	NMRA MCR Div. 5, 440-357-8890
3/24/2018	Mt. Hope Train & Toy Show	Mt. Hope, OH - Mt. Hope Event Ct.	Jon Ulbright, 330-262-7488
3/25/2018	Massillon Train & Toy Show	Massillon, OH - Knights of Columbus Hall	Jon Ulbright, 330-262-7488
3/25/2018	Springfield Model Train Show	Springfield, OH - Clark County Fairgrounds	Bob Chaffin, 937-399-6647
4/8/2018	Toy Train & Model RR Flea Market	Salem, OH - Salem Center Plex	Youngstown Model RR Assoc. 330-547-3614
4/8/2018	Great Midwest Train Show	Wheaton, IL - DuPage County Fair Grounds	greatmidwesttrainshow.com
4/8/2018	Medina Toy & Train Show	Medina, OH - Medina Fairgrounds	Conrad & Dowdell Productions 330-948-4400
4/8/2018	Wolverine Railroad Toy & Train Show	Madison Heights, MI - UF & C Workers Hall	Wolverine Model RR Club (586) 662-0225
4/14/2018	Grand River Valley Spring Train Show Wyoming, MI - HSB (Home School Bldg)	Grand River Valley RR Club	
4/14/2018	32nd Annual Bucyrus Train Show	Bucyrus, OH - Crawford County Fairgrounds	David Moore 419-462-5035
4/21/2018	63rd Buckeye Model Train Show	Columbus, OH - Lausche Bldg., Ohio Expo Center	Gordon Hartranft 330-755-6526
4/29/2018	Muskegon Train Show	Muskegon, MI - LST 393	Muskegon RR Hist. Soc. 231-670-0751
5/5/2018	TCA - Springtime Train Meet	Cleveland (Parma), OH - UAW Hall	TCA - Lake Erie Chapter 440-845-2700
5/5/2018	11th Annual National Train Day	Toledo, OH - Toledo Amtrak Station	Bill Gill, 419-241-9155 x134
5/5/2018	Model Train Days (2 Days)	Painesville, OH - Painesville Railroad Museum	Painesville RR Museum 440-417-6746
5/6/2018	Great Midwest Train Show	Wheaton, IL - DuPage County Fair Grounds	greatmidwesttrainshow.com
5/6/2018	Blue Water Railroad Show & Swap Shop	Port Huron, MI - Blue Water Convention Center	Blue Water Convention Center 810-201-5513
5/17/2018	NMRA Mid-Central Region Convention	West Chester, OH - Cincinnati Marriott North	NMRA MCR Cincinnati Div. 7
5/20/2018	Durand Model Train Show	Durand, MI - Durand Middle School	Tim Colton 810-845-4908
5/20/2018	Montpelier Tracksider Modelers Train Show	Montpelier, OH - Holiday City Quality Inn Convention Center	Jim McPike, 419-298-2441
6/2/2018	Bradford Railroad Heritage Festival	Bradford, OH - Bradford Railroad Museum	Bradford Railroad Museum (740) 653-2220
6/3/2018	Great Midwest Train Show	Wheaton, IL - DuPage County Fair Grounds	greatmidwesttrainshow.com
6/10/2018	42 nd Annual Kane County Railroadiana & Model Train Show	St Charles, IL - Kane County Fairgrounds	RussFierce@aol.com, 847-358-1185
7/28/2018	Railroad Heritage Wkd Show & Swap	Van Wert, OH - Van Wert Co. Fairgrounds	Jan Dunlap 419-238-4207
8/12/2018	Great Midwest Train Show	Wheaton, IL - DuPage County Fair Grounds	greatmidwesttrainshow.com
8/18/2018	Everett's Train Show	Marion, OH - Marion Union Station	740-351-1798

The History Corner

Here's a follow up note I got from Larry Hickman on the cover photo as shown on the Oct. Train Order. In case you don't remember, it's the old coaling tower (we now have a name) on US 23 near Marion, Ohio.

This is the stuff that makes this job worth while!

The Editor

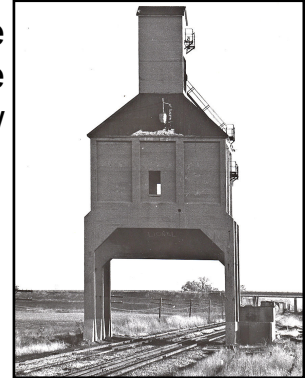

From: LARRY D
Sent: Thursday, October 26, 2017 9:11 AM
To: Huber, Ray
Subject: Harvey Coaling Dock

Ray,

The Harvey Coaling Station is still standing just north of Marion. I ran over this line from Carrothers to Columbus when I first hired out on the PRR back in 1966. At this location most northbound and southbound steam engines stopped to refill their tenders in the early years. This portion of the old PRR Short Line was sold to the N&W Railway back in 1964. One of the first things after the purchase was to cut the top off the PRR Keystone Whistle Post all across the line between Columbus and Sandusky. Trains departing Sandusky, Bellvue and Toledo terminated at Groghan Yard in downtown Columbus. If I remember correctly the yard and depot was demolished back in the the late 80s for the new by pass through the downtown area. There was also a block operator at this location, where train orders were issued if needed. There is a great DVD showing this in operation on one of the PRR DVDs by Don Croffta.

Larry Hickman

Looking for Suggestions

Within Division One, how many of you can find your way around the software program Cad Rail well enough to produce a finished layout drawing? That is, showing all the curves, reverse curves, diamond crossings, turn-outs, crossovers and all the rest of the details that go into making a layout plan.

Steve Kepela, is new to Division One and is asking for help. He just purchased Cad Rail, Version 10 and is looking for help. If you know enough to get started, just say so and at the same time, think about putting on a live clinic so all of us can benefit.

Estate Train Sale

Al Grigsby, long time member of NMRA and Division One is moving to smaller quarters. As a result, his layout will not be moved! See the ad below for more details.

From: "Al Grigsby" <amgrigs@gmail.com>
To: <rahuber@bex.net>
Subject: Train layout dismantling
Date: Tuesday, November 14, 2017 8:24 PM

Hi Ray,

I am moving to Swan Creek retirement in January. I am dismantling the S & S RR. Most buildings, details, tools, old paints, scenery and trains are for sale. I plan on holding a flea market in my basement on Saturday and Sunday, December 16 & 17 from 1pm to 5 pm. This date can be moved if necessary.

I would like to notify all the division one members of this event so they have first choice at my treasures. Is it okay for me to use the roster mailing list? If not can I buy an ad in the bulletin?

I have 2 tables at the Owens flea market next year for what ever is left over. Obviously the less I have to haul over there the better.

Al Grigsby

NOTICE

TO ALL!

Here's a request from Division member/s looking for a special item you might have stashed away on a shelf in your supply closet or just sitting around gathering dust. We mentioned this service at Division a couple of times and this is our first request. If you can help, the contact info is included with the notice.

The Editor

Item #1

Help Wanted!

I'm looking for a couple of Atlas house kits that are out of production. They are:

#711 Kate's Colonial Home

#712 Barb's Bungalow

Do you have one or both of these kits and are you interested in selling them? If so, please email me at davemcmullian@earthlink.net or call me at 419-508-2206. I know they are also available as pre-built structures, but I need them in kit form.

Thanks!!

Dave McMullian

Item #2

Steve Kellogg is looking for the item shown in the picture to the right. It's an Atlas product and was used as a switch controller. I have never seen one. Maybe you have and, better yet, have one or know where there is one or more. If so, please contact Steve Kellogg at atsfmktrock@yahoo.com



The Editor

NOTICE

Item 3

On the Web

Looking for some screen time? Try this link. Gary Chudzinski sent this link to me to share with you. Boy, was I surprised at the content. It seems that when you are done with one site, You Tube takes you on to something else. After 3 hours, I gave up! Lot's of railroad stuff! Not sure how it will work on your system, but I was impressed with what I saw.

<https://www.youtube.com/watch?v=Ka7LC1jia64>

Item 4

From: Marshall Stull" <mstull@marshallstull.com>
To: <rahuber@bex.net>
Subject: Recommendation for next Train Order

So I recently found out that our NMRA membership can be used to get discounts from manufacturers. According to the NMRA website (you have to log-in to find it) the new "NMRA Partnership Program" (<https://www.nmra.org/members/partnership-program>) works with model railroad manufacturers to provide a discount as a member benefit.

I do not think most members know about this. It was announced at the 2017 convention but unless you were in attendance or watch the NMRA website close you would not know about it.

I think it might be a good idea to mention it in the next Train Order and maybe even at the next meeting.

Marshall Stull

Portable Layout

The Origin of a Portable Layout

Here's a little something I dreamed up one day as I was getting ready to "pitch" some excess material. The material consisted of 1x4's, 1/2" plywood, Homosite, lots of BRASS snap track (straight track, #6 custom turnouts and the jewel an old #6 BRASS Double Slip Switch by ???).

Looking at what I had, I said to myself, SELF, you have the makings of what you always wanted, a small Portable Shelf Railroad. The inspirational piece was the Homosite at 9" wide x 6'-2.5" long – can't waste that!

Again and I've said it before, your imagination is paramount to this hobby. With that thought in mind, I just started laying track on the Homosite with no plan in mind except to get as much as possible in the space I had.

Before long and to my amazement, I had a very creditable looking switching/portable layout. Thanks in no small way to that Double Slip Switch – what a space saver!

To make it portable, I added a cover mounted with a long piano hinge some catches and a handle to carry it with.

OK, it's built – now what? Soon got tired of just moving a couple of cars around for no reason and this got me thinking. How can I make this operation more interesting and hopefully fun for others?

Given all the hype about OPS secessions, thought I might as well join in on the fun. If you will bear with me, you will see what I came up at a later date. I called it Operation Short Haul. It can be operated with one person but, I would like to see at least 3 people operating the layout. As planned, It can be a challenge and at the same time, easy to follow and operate.

Ray Huber

PS The 1st edition was built simply using standard DC wiring with no blocks. Since then, the layout has been converted to work with DCC – WOW can you see the mayhem with more than one locomotives? We even have a programming track for newcomers.

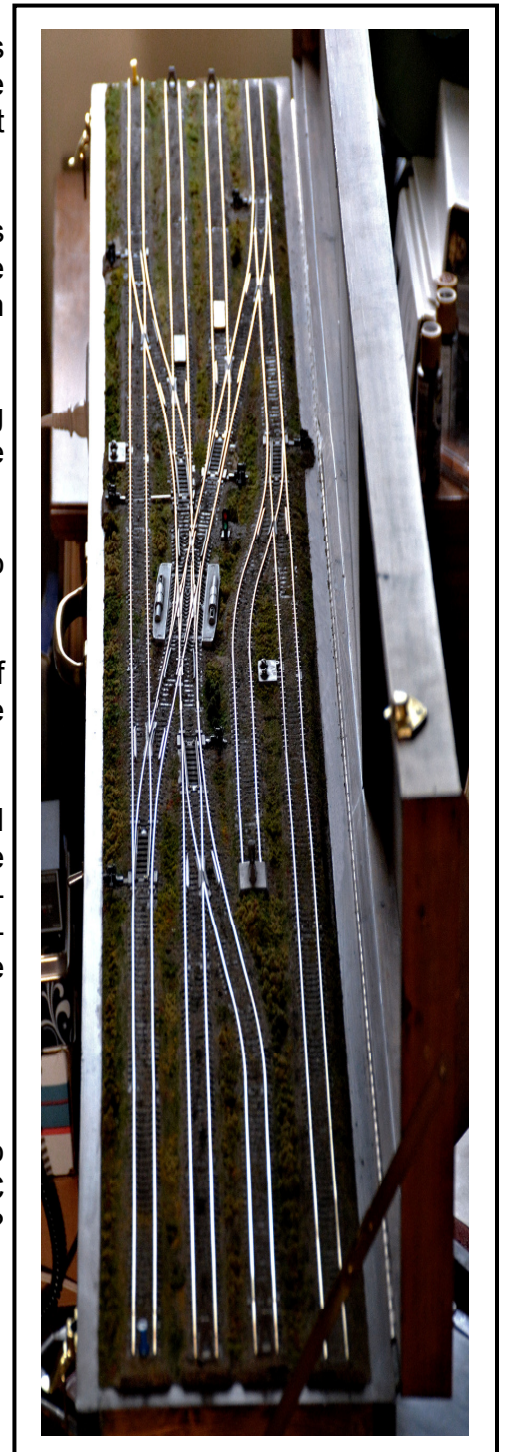

Member Layout



Ray Hahn



Long time member Phil Kauffman and former Agent of Division One has a growing railroad that's worth seeing. All DCC, some scenery and lot's of PRR loco's. The track work is great and all runs well except on visitation night. Don't ask Phil why I said that!

There are 19 stalls in his engine house and he has 19 loco's to fill them. That's a lot of steam but, as you can see, he has the service facilities laid out very nicely.

Wait a minute, where did that maverick NYC loco come from? I'll never tell!



The Editor

Won't you come and join us—all are welcome.

We meet at the Proclaim FM Radio station (WPOS) located at 7112 Angola Rd. (north side) and Clark St. in Holland, Ohio, about 1 mile West of McCord Rd. See the location map shown below. The doors open at **6:00 PM** and the meeting starts at **7:00 PM**.

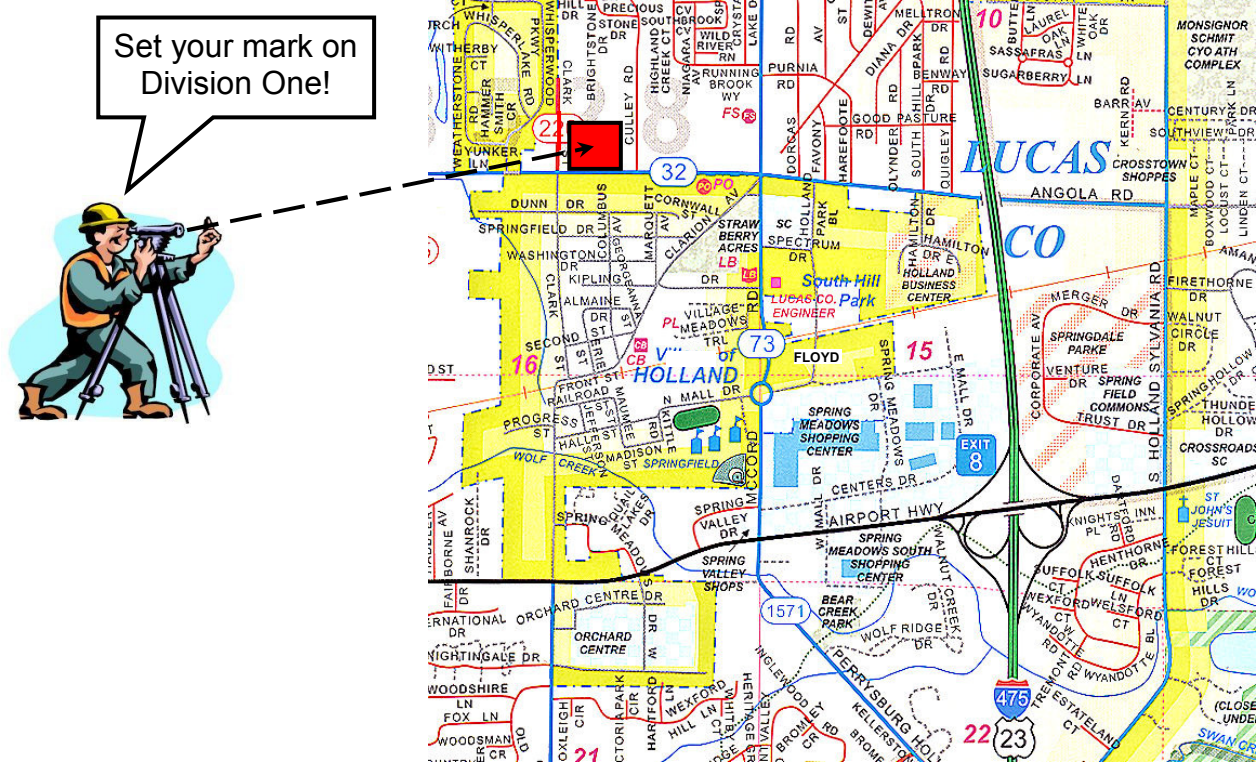

CURRENT OFFICERS 2014 - 2015

- Superintendent -Dave McMullian.....davemcmullian@earthlink.net
- Assistant Superintendent -Norm Cattell.....nacattell@bex.net
- Chief Clerk -John Roth.....jroth@bex.net
- Agent -John Gardner.....jgard2pb@aol.com
- Trainmaster for Services -Steve Kellogg.....atsfmktrock@yahoo.com
- Director at Large -Norris Hinds.....nphinds@embarqmail.com
- Director at Large -Ray Huber.....rahuber@bex.net
- Train Order Editor -Ray Huber.....rahuber@bex.net
- Librarian -Dex Decker.....dexdecker@gmail.com

Division One is a 100% NMRA membership organization. For insurance purposes, you are required to be a member of NMRA. Membership in NMRA grants you membership in both the North Central Region and Division One.